

SCALE 0.500

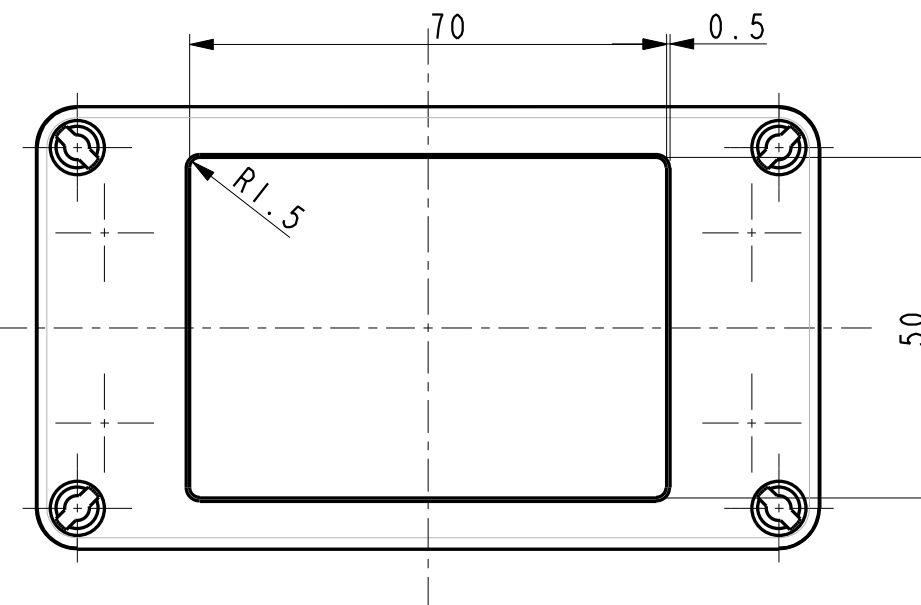
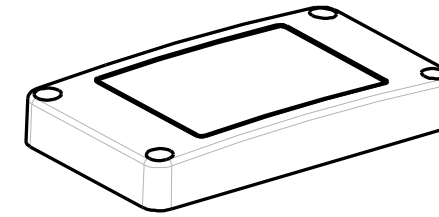

Outer surfaces: Charmilles 28 ( $R_a 2,3 \mu m$ )  
except label area 70 X 50 : smooth (polished)

The outer label area (71 X 51)  
must be made as an insert in the tool.

Dato: 29-Jan-09	<b>BERNIC A/S</b>		
Skala: 1.000	Kunde:	Sheet 1 of 1	
Tol.: DS/ISO 2768 - m	Materiale: Polycarbonate	Farve: Grey RAL 7035	
Emne nr.:	3D model: COVER_203-5_CURVED	Tegn. nr.: BC 288	
Betegnelse:	Sealed enclosure type 203, curved cover, rev. 5		Fil: COVER_203-5_CURVED